



Service You Can Build On

Carpenters' Moulding Guide

O R E G O N

503•223•8818

GoWestPac.com



For over 30 years, locally owned Western Pacific has been supplying the building industry with quality products for new home construction.

As an environmentally and socially conscious Oregon company, we source the majority of our windows, doors and mouldings from regionally owned and operated manufacturers in the Pacific Northwest.

Our mission is to supply quality products on-time to meet evolving homebuilders' needs.

We thank you for your business and look forward to working with you on your home.

SERVICES



JOB SITE TAKEOFF

Our experienced, professional team will walk your jobsite and do a detailed takeoff, including as needed: prehung doors, millwork, stairparts, locks & hardware, and windows.



PREHUNG DOORS

Your dedicated WestPac team will machine and assemble our quality doors together with jambs, brickmould, weatherseals, and other components into a ready-to-install unit, with great care and quality in mind.



CUSTOM DOORS

If you're aiming for unique interior design, or exclusive entry doors, we have experts on hand who will transform your creative vision into reality.



CUSTOM MILLWORK

Whether it's beautiful arch surrounds and casing, custom run moulding patterns, or exotic wood species, we have you covered with WestPac's experienced custom millwork shop.



HAND PULLED MOULDING PACKS

We take pride in our vast assortment of casing, base, crown, and closet material, and we'll handle with care as we package your items in the quantities and lengths you need.



JOB SITE DELIVERY

We deliver, rain or shine, on time to your jobsite. We get your order right and deliver it to your site quickly, so you can meet your deadlines with no surprises.



MOBILE APP

Maximize your efficiency by getting up-to-the-minute updates on your order status and delivery schedule by using our WestPac mobile app.

BASIC MOULDING TERMINOLOGY

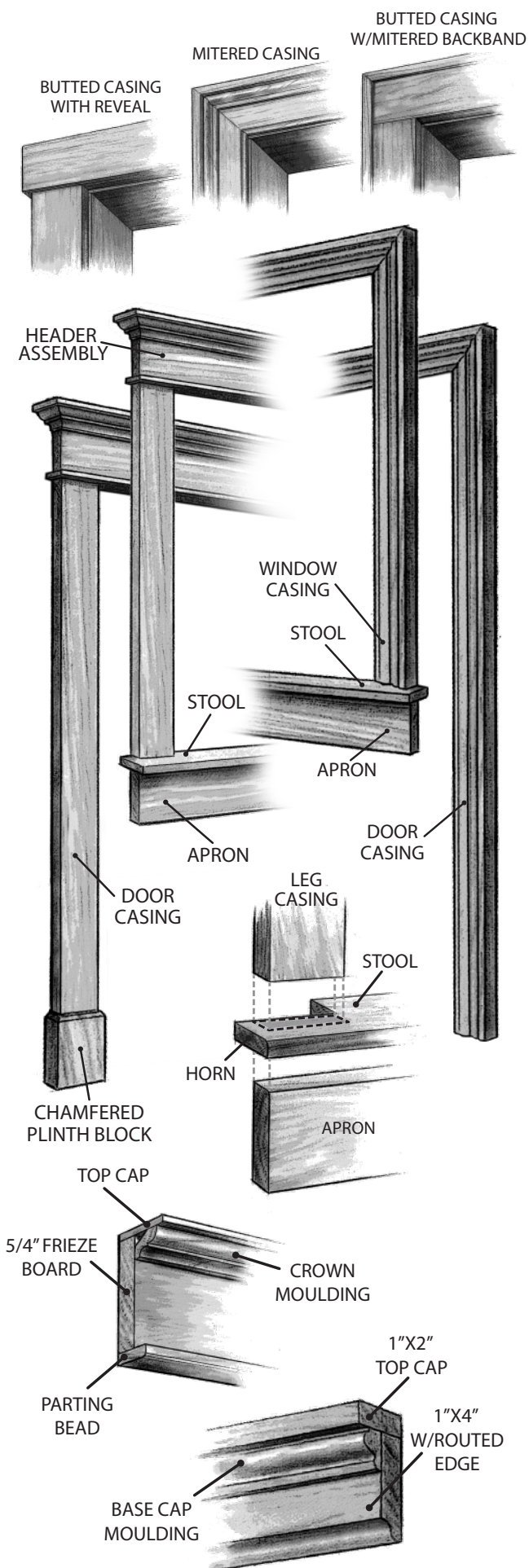

TRANSITIONAL

Style

M

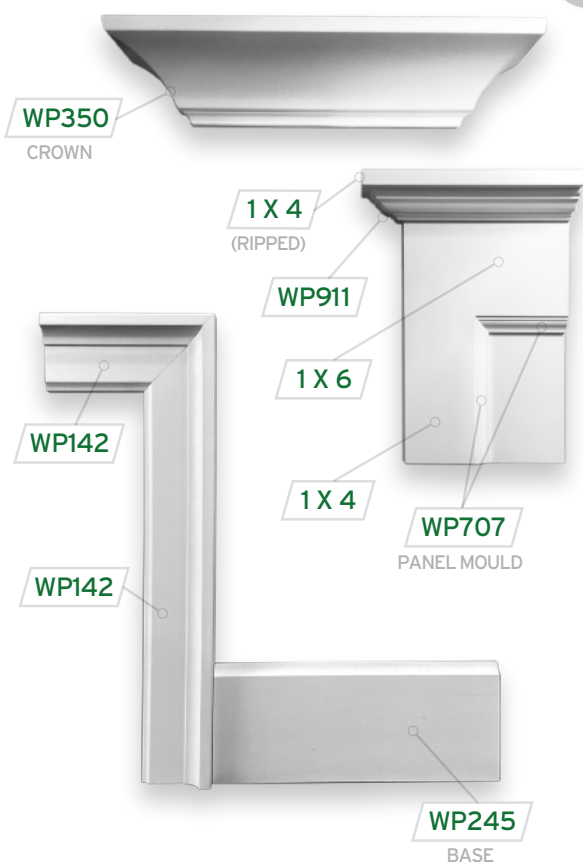

CLASSIC

Style

A

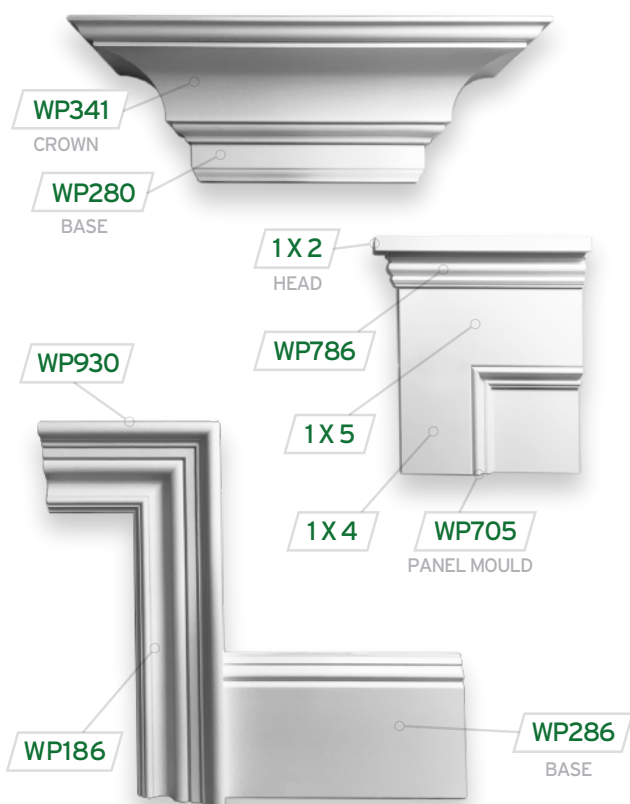

CLASSIC

Style

C

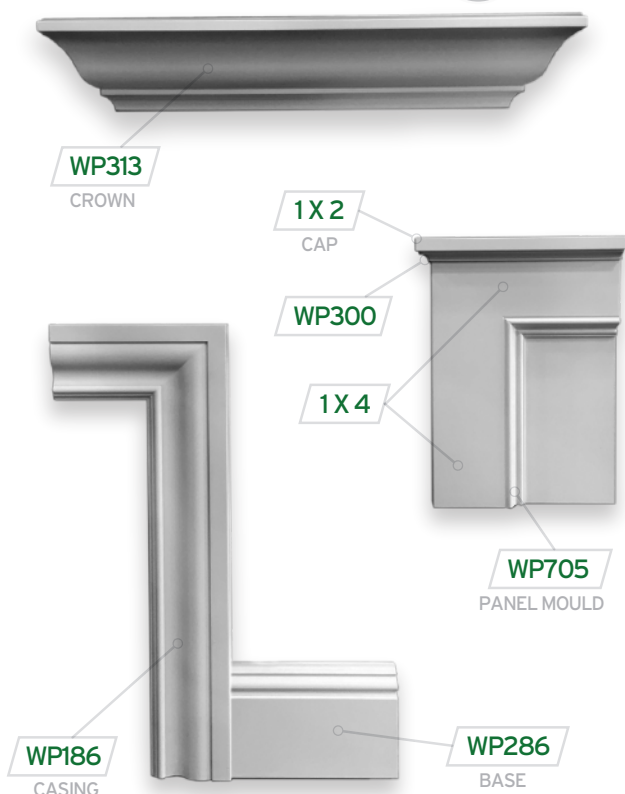

CLASSIC

Style

D



CRAFTSMAN

Style

G



CRAFTSMAN

Style

I



CRAFTSMAN

Style

E

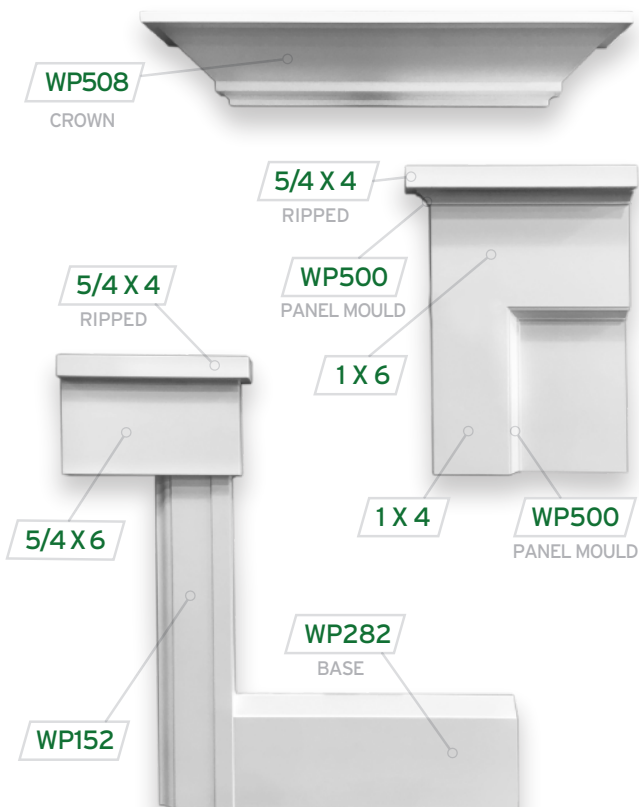

CRAFTSMAN

Style

F

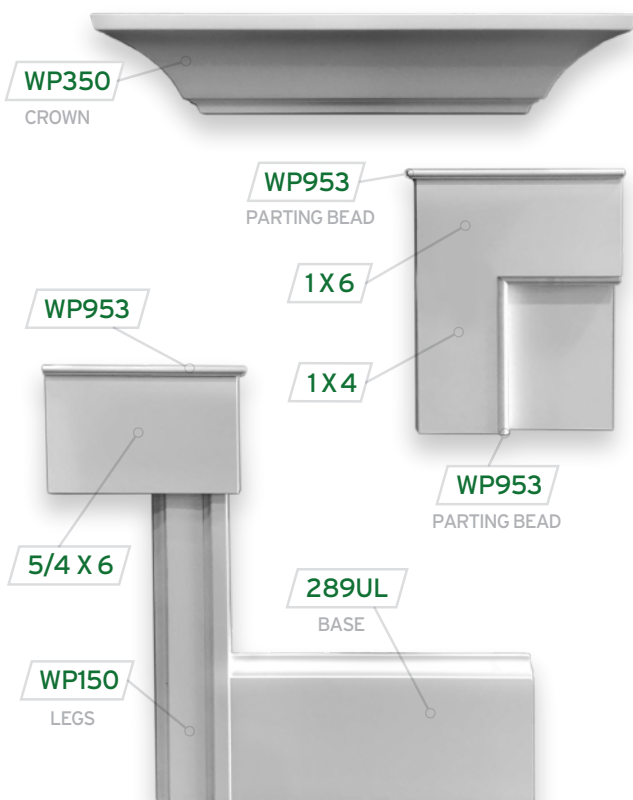

Moulding dimensions subject to change without notice, contact your local WestPac office for correct dimensions



WP183

CASING
5/8" X 2-1/4"



WP186

CASING
11/16" X 3-1/2"



WP184

CASING
1" X 3-1/2"



WP188

CASING
1-1/16" X 5-1/4"

Moulding dimensions subject to change without notice, contact your local WestPac office for correct dimensions



WP142

CASING
1" X 3-1/4"



WP144

CASING
1" X 4-1/4"



WP143

CASING
11/16" X 3-1/4"



WP145

CLASSIC CASING
5/8" X 2-1/4"

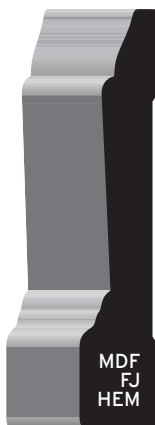

WP150

CLASSIC CASING
5/8" X 3-1/4"



WP154

CLASSIC CASING
13/16" X 4-1/4"

MOULDING

FLAT STOCK

INTERIOR DOORS

STAIR PARTS

HARDWARE

TECHNICAL INFORMATION

NOTES

Moulding dimensions subject to change without notice, contact your local WestPac office for correct dimensions



WP152

MODERN CLASSIC
CASING
9/16" X 3-1/2"



WP155

MODERN CLASSIC
CASING
3/4" X 4-1/4"



WP156

COLONIAL CASING
HEM • 9/16" X 2-1/4"
FJ • 5/8" X 2-1/4"

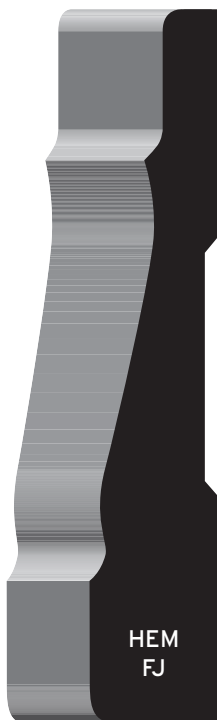

WP160

COLONIAL CASING
5/8" X 3-7/16"

Moulding dimensions subject to change without notice, contact your local WestPac office for correct dimensions



WP114

BULLNOSE CASING
11/16" X 3-1/4"



WP175

BULLNOSE CASING
9/16" X 2-1/4"



WP100

BULLNOSE CASING
3/8" X 1-1/4"



WP174

CASING
Economy
7/16" X 2-1/4"



WP176

CASING
Economy
7/16" X 3-1/2"

MOULDING

FLAT STOCK

INTERIOR DOORS

STAIR PARTS

HARDWARE

TECHNICAL INFORMATION

NOTES

Moulding dimensions subject to change without notice, contact your local WestPac office for correct dimensions



WP190

TRADITIONAL
CASING
9/16" X 2-1/4"



WP111

TRADITIONAL
CASING
HEM • 7/8" X 3-1/4"
MDF • 13/16" X 3-1/4"

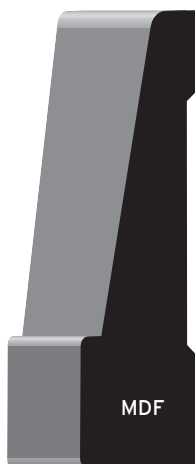

WP185

MODERN
CASING
11/16" X 3-1/4"



WP180

MODERN
CASING
11/16" X 2-1/4"



WP105

SANITARY
1/2" X 1-1/2"

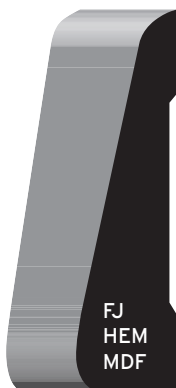

WP130

SANITARY
9/16" X 2-3/16"

Moulding dimensions subject to change without notice, contact your local WestPac office for correct dimensions



MDF

WP281

MODERN BASE
9/16" X 3-1/4"



MDF

WP282

MODERN BASE
9/16" X 5-1/4"



MDF

WP287

9/16" X 7"



MDF

WP286

9/16" X 5-1/4"



MDF

WP283

9/16" X 3-1/4"

Moulding dimensions subject to change without notice, contact your local WestPac office for correct dimensions



MDF

WP247

BASE
9/16" X 7-1/2"

MDF

WP245

BASE
9/16" X 5-1/4"

MDF

WP289

BASE
9/16" X 7"

FJ
HEM
MDF

WP285

BASE
9/16" X 5-1/4"

FJ
HEM
MDF

WP280

BASE
7/16" X 3-1/4"

Moulding dimensions subject to change without notice, contact your local WestPac office for correct dimensions



WP275

BASE
7/16" X 3-1/4"



WP274

BASE
Economy
3/8" X 3-1/4"



WP279

BASE
3/8" X 3-1/4"
Economy



WP284

BASE
3/8" X 5-1/4"
Economy

PROFILES ARE NOT NECESSARILY ACTUAL SIZE

Moulding dimensions subject to change without notice, contact your local WestPac office for correct dimensions



PMDF124

BASE
1/2" X 3-1/2"



PMDF126

BASE
1/2" X 5-1/2"



PMDF128

BASE
1/2" X 7-1/4"

Moulding dimensions subject to change without notice, contact your local WestPac office for correct dimensions



47UL

TRADITIONAL CROWN
5/8" X 4-1/4"



WP313

TRADITIONAL CROWN
9/16" X 4-1/4"

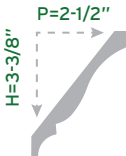

512

TRADITIONAL CROWN
5-1/4" X 9/16"



WP312

TRADITIONAL CROWN
HEM
9/16" X 3-1/4"
MDF
9/16" X 3-5/8"

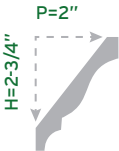

WP354

TRADITIONAL CROWN
9/16" X 2-1/4"



WP368

TRADITIONAL CROWN
9/16" X 1-5/8"



Moulding dimensions subject to change without notice, contact your local WestPac office for correct dimensions



508

CRAFTSMAN CROWN
3/4" X 4-5/8"

P=3-1/8"

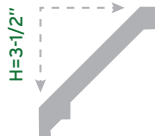

500

PANEL MOULD
5/8" X 5/8"



501

PANEL MOULD
3/4" X 3/4"

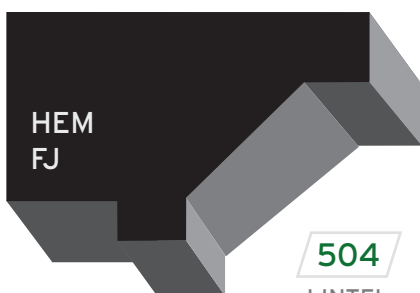

504

LINTEL
1-1/2" X 2-3/8"



WP911

LINTEL
1-3/16" X 2-1/4"

Moulding dimensions subject to change without notice, contact your local WestPac office for correct dimensions

CRAFTSMAN CROWN
11/16" X 7-1/2"

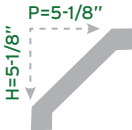

MDF

509

CRAFTSMAN CROWN
11/16" X 5-1/4"



MDF

507

CRAFTSMAN CROWN
11/16" X 3-1/4"



HEM
FJ
MDF

506

Moulding dimensions subject to change without notice, contact your local WestPac office for correct dimensions



F315

BED MOULDING
3/4" X 2-5/16"

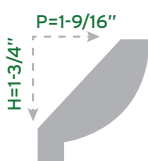

F543

BED MOULDING
11/16" X 3-1/4"



H311

BED MOULDING
1/2" X 2-5/8"

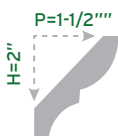

H310

BED MOULDING
1/2" X 1-9/16"



Moulding dimensions subject to change without notice, contact your local WestPac office for correct dimensions



WP308

CROWN
3/4" X 3-1/4"



WP309

CROWN
3/4" X 5-1/4"



WP310

CROWN
1" X 7"

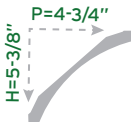

Moulding dimensions subject to change without notice, contact your local WestPac office for correct dimensions



MDF

WP353

CROWN
9/16" X 3-1/2"

P=2-9/16"



H=2-7/16"



MDF
ALD

WP350

CROWN
5/8" X 5-3/16"

P=3-9/16"



H=3-15/16"



MDF

WP341

CROWN
1-3/16" X 6-5/16"

P=4-1/2"



H=4-1/2"

Moulding dimensions subject to change without notice, contact your local WestPac office for correct dimensions

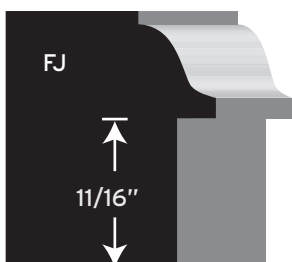

WP922

BACKBAND
1-5/16" X 1-1/8"

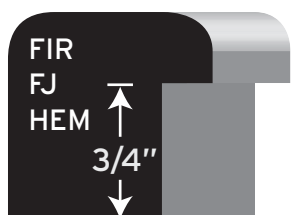

1021

BACKBAND
1-1/16" X 1-1/16"

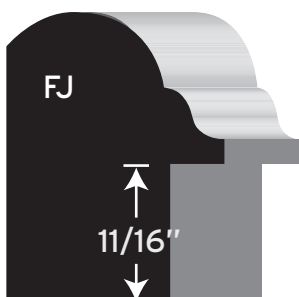

WP930

BACKBAND
1-1/8" X 1-1/2"

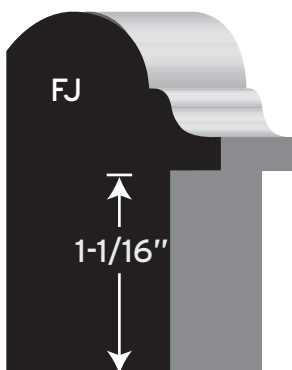

WP935

BACKBAND
1-7/8" X 1-1/8"

Moulding dimensions subject to change without notice, contact your local WestPac office for correct dimensions



WP1000

CHAIR RAIL
11/16" X 2-5/8"



WP711

CHAIR RAIL
11/16" X 1-1/2"

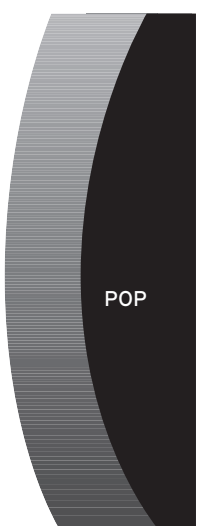

WP980

CHAIR RAIL
3/4" X 3-1/4"



WP752

CHAIR RAIL
1-1/16" X 5-3/8"



WP1004

CHAIR RAIL
9/16" X 2-1/2"

Moulding dimensions subject to change without notice, contact your local WestPac office for correct dimensions



WP702

PANEL MOULD
9/16" X 1-1/8"



WP703

PANEL MOULD
11/16" X 7/16"



WP705

PANEL MOULD
3/4" X 1-1/8"



WP701

PANEL MOULD
3/4" X 1-1/8"



WP706

PANEL MOULD
3/4" X 2"



WP707

PANEL MOULD
5/8" X 3/4"

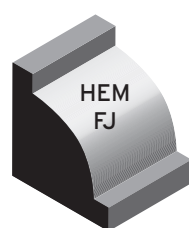

WP704

PANEL MOULD
5/8" X 5/8"

Moulding dimensions subject to change without notice, contact your local WestPac office for correct dimensions

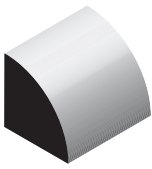

WP324

QUARTER ROUND
3/4" X 3/4"
HEM

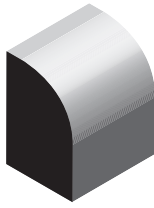

WP451

BASE SHOE
7/16" X 11/16"
FJ • HEM • ALD • OAK

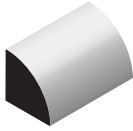

WP322

QUARTER ROUND
1/2" X 1/2"
HEM

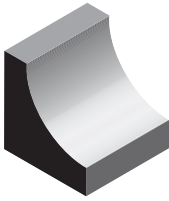

WP301

COVE
3/4" X 3/4"
HEM

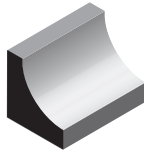

WP300

COVE
1/2" X 1/2"
HEM

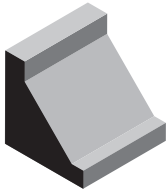

500

PANEL MOULD
5/8" X 5/8"
HEM



503

1/2" X 1-1/8"
FJ

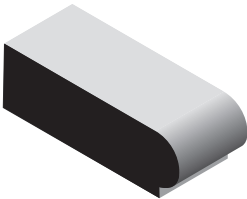

WP953

PARTING BEAD
7/16" X 1-3/8"
HEM • FJ



3/4 SQUARE

3/4" X 3/4"

FJ347

FJ (7' Specified)

H34

HEM (Random Lengths)

Moulding dimensions subject to change without notice, contact your local WestPac office for correct dimensions

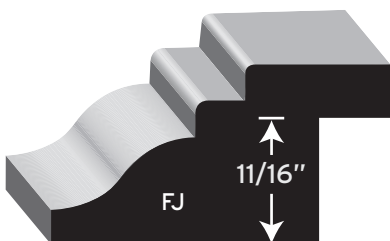

WP712

PANEL MOULD
15/16" X 1-3/4"



WP789

BASE CAP
7/16" X 15/16"



WP786

BASE CAP
9/16" X 1-5/8"

INSTALLED
APPEARANCE



SL126

SHIP LAP
1/2" X 5-5/16"



SL128

SHIP LAP
1/2" X 7-5/16"

Moulding dimensions subject to change without notice, contact your local WestPac office for correct dimensions



WP5020

ARCHITRAVE
1-3/16" X 5-1/4"



WP3244

Miscellaneous
9/16" X 1-1/4"



WP3248

Miscellaneous
1-3/16" X 2-1/2"



WP5000

ARCHITRAVE
1-3/16" X 3-3/4"

Moulding dimensions subject to change without notice, contact your local WestPac office for correct dimensions

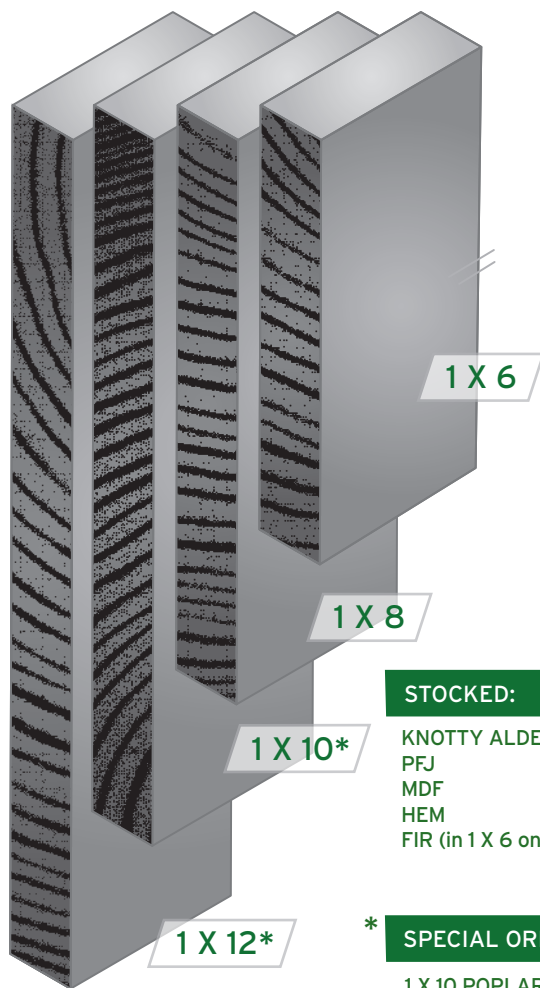

STOCKED:

KNOTTY ALDER
PFJ
MDF
HEM
FIR (in 1 X 6 only)

*

SPECIAL ORDER:

1 X 10 POPLAR
1 X 10 SELECT ALDER
1 X 12 SELECT ALDER



STOCKED IN:

MDF
HEM

MOULDING

FLAT STOCK

EXT FG DOORS

INT DOORS

STAIR PARTS

HARDWARE

TECHNICAL INFORMATION

NOTES

Moulding dimensions subject to change without notice, contact your local WestPac office for correct dimensions

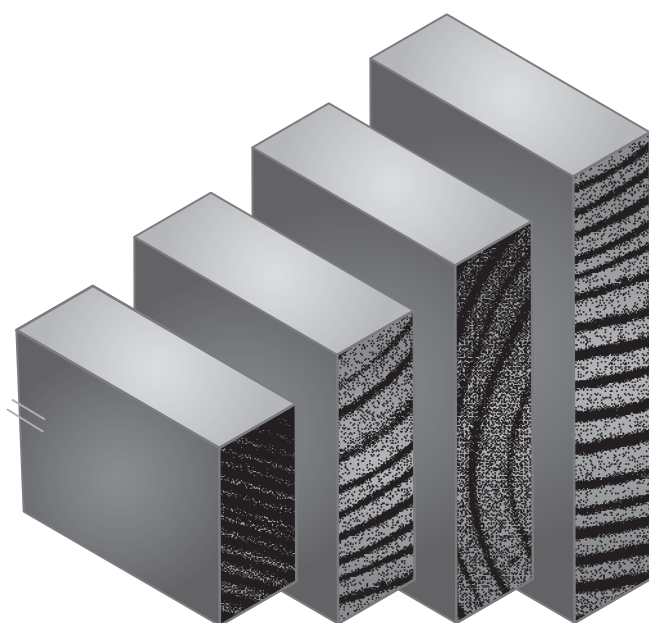

1 X 2

1 X 3

1 X 4

1 X 5

STOCKED IN:

SELECT ALDER
KNOTTY ALDER
PFJ
MDF
HEM
POP
FIR(1 X 4 & 1 X 5)

SPECIAL ORDER:

FIR
OAK
MAPLE
CHERRY

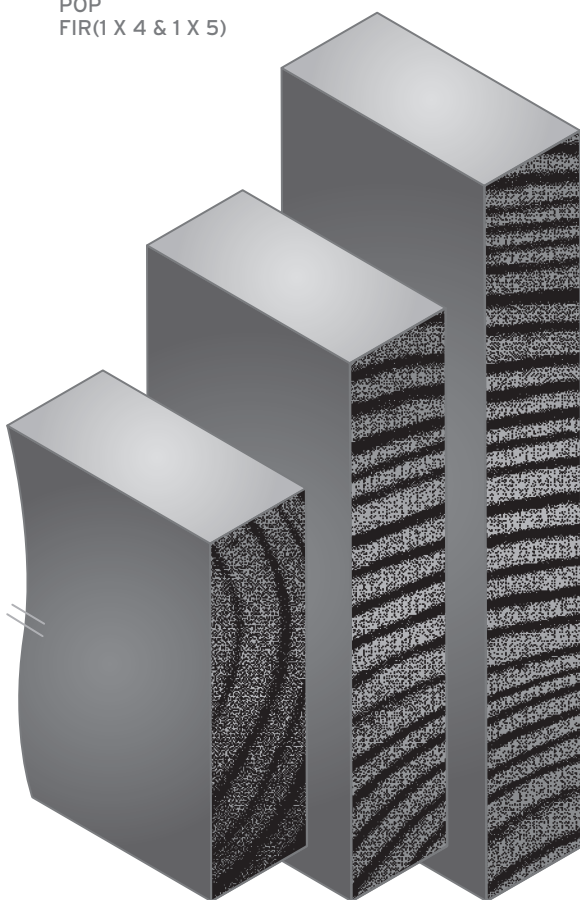

5/4 X 4

5/4 X 6

5/4 X 8

STOCKED IN:

KNOTTY ALDER
PFJ
MDF
HEM

AVAILABLE IN:

FIR
OAK
POPLAR
MAPLE
CHERRY

ROUGH OPENINGS

MOULDING

FLAT STOCK

EXT FG DOORS

INT DOORS

STAIR PARTS

HARDWARE

TECHNICAL INFORMATION

NOTES

Moulding dimensions subject to change without notice, contact your local WestPac office for correct dimensions

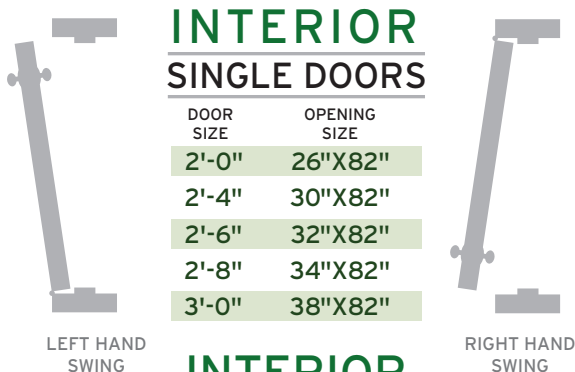

INTERIOR SINGLE DOORS

DOOR SIZE	OPENING SIZE
2'-0"	26"X82"
2'-4"	30"X82"
2'-6"	32"X82"
2'-8"	34"X82"
3'-0"	38"X82"

LEFT HAND
SWING

RIGHT HAND
SWING

INTERIOR

ASTRAGAL PAIRS

DOOR SIZE	OPENING SIZE
2'-0"	50-1/2"X82"
2'-4"	58-1/2"X82"
2'-6"	62-1/2"X82"
2'-8"	66-1/2"X82"
3'-0"	74-1/2"X82"

BALL CATCH PAIRS

DOOR SIZE	OPENING SIZE
2'-0"	50"X82"
2'-4"	58"X82"
2'-6"	62"X82"
2'-8"	66"X82"
3'-0"	74"X82"

INTERIOR

BIFOLDS

DRYWALL JAMB:
(DOOR WIDTH + 1-1/4")

BIPASS DOOR

DRYWALL JAMB:
(DOOR WIDTH X 2)

WOOD FULL JAMB:
(DOOR WIDTH + 2")

WOOD FULL JAMB
(DOOR WIDTH X 2) + 1"

POCKET DOOR

WOOD FRAME
(DOOR WIDTH X 2) + 2"
(DOOR HEIGHT) + 4"
EXAMPLE: 2668 = 62" X 84"

JOHNSON FRAME
(DOOR WIDTH X 2) + 1"
(DOOR HEIGHT) + 4-1/2"
EXAMPLE: 2668 = 61" X 84-1/2"

EXTERIOR

EXTERIOR SINGLE DOORS

	6/8	7/0	8/0
2' 6"	32" X 82"	32" X 87"	32" X 99"
2' 8"	34" X 82"	34" X 87"	34" X 99"
2' 10"	36" X 82"	36" X 87"	36" X 99"
3' 0"	38" X 82"	38" X 87"	38" X 99"

12" TRANSOMS OVER 6'8" DOORS
ARE NORMALLY 94-1/2" HEIGHT

EXTERIOR SIDELITE UNIT

ONE SIDELITE, ONE DOOR
(DOOR WIDTH) + (S/L WIDTH) + 3-1/2"

TWO SIDELITES, ONE DOOR
(DOOR WIDTH) + (S/L WIDTH X 2) + 5"

TWO SIDELITES, TWO DOORS
(DOOR WIDTH X 2) + (S/L WIDTH X 2) + 6"

6' 8" HEIGHT: 82"

7' 0" HEIGHT: 87"

8' 0" HEIGHT: 99"

EXTERIOR PAIRS

(DOOR WIDTH X 2) + 3"

6' 8" HEIGHT: 82"

7' 0" HEIGHT: 87"

8' 0" HEIGHT: 99"

RAISED PANEL DOORS

MOULDING

FLAT STOCK

EXT FG DOORS

INT DOORS

STAIR PARTS

HARDWARE

TECHNICAL INFORMATION

NOTES

ROMAN

SMOOTH
PASSAGE/BIFOLD
6/8 • 8/0

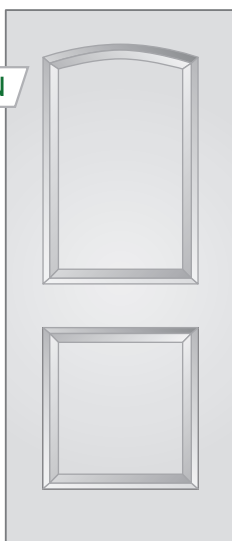

CARRARA

SMOOTH
PASSAGE/BIFOLD
6/8 • 8/0

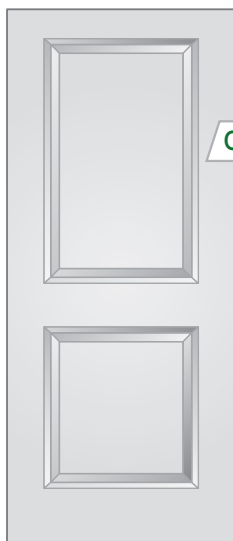

ROCKPORT

SMOOTH
PASSAGE/BIFOLD
6/8 • 8/0



SANTA FE

SMOOTH
PASSAGE/BIFOLD
6/8 • 8/0



COLONIST

SMOOTH or TEXTURED
PASSAGE/BIFOLD
6/8 • 8/0



FLAT PANEL DOORS

MOULDING

FLAT STOCK

EXT FG DOORS

INT DOORS

STAIR PARTS

HARDWARE

TECHNICAL INFORMATION

NOTES

MADISON

FLAT PANEL
SMOOTH
PASSAGE/BIFOLD
6/8 • 8/0

MONROE

FLAT PANEL
SMOOTH
PASSAGE/BIFOLD
6/8 • 8/0

BIRKDALE

FLAT PANEL
SMOOTH
PASSAGE/BIFOLD
6/8 • 8/0

CRAFTSMAN

FLAT PANEL
SMOOTH
PASSAGE/BIFOLD
6/8 ONLY

CONMORE

FLAT PANEL
SMOOTH
PASSAGE/BIFOLD
6/8 ONLY

MELROSE

SMOOTH
PASSAGE/BIFOLD
FLUSH W/KERF LINES
6/8 • 7/0

BERKLEY

SMOOTH
PASSAGE/BIFOLD
FLUSH W/KERF LINES
6/8 • 7/0

CASCADE FLAT PANEL DOORS

SHAKER/SQUARE STICKING • FLAT PANEL
1-3/8" • STILE & RAIL • 6/8 & 8/0
(1-3/4" AVAILABLE IN 2/8 AND 3/0 WIDTHS)

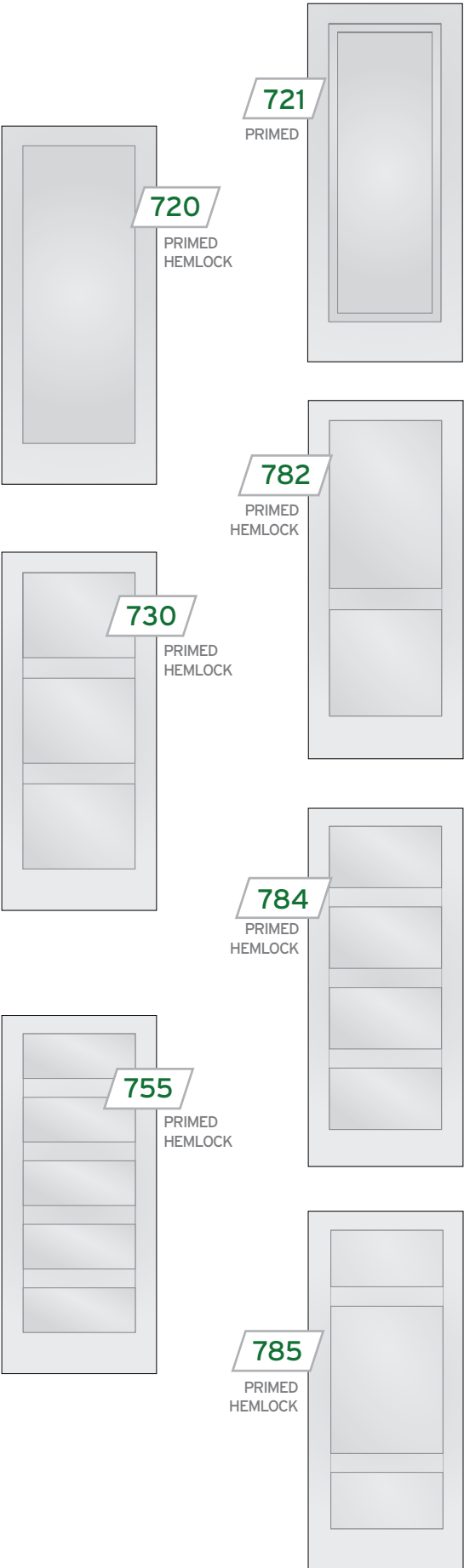

MOULDING

FLAT STOCK

EXT FG DOORS

INT DOORS

STAIR PARTS

HARDWARE

TECHNICAL INFORMATION

NOTES

CASCADE FLAT PANEL DOORS

SHAKER/SQUARE STICKING • FLAT PANEL
1-3/8" • STILE & RAIL • 6/8 & 8/0
(1-3/4" AVAILABLE IN 2/8 AND 3/0 WIDTHS)

MOULDING

FLAT STOCK

EXT FG DOORS

INT DOORS

STAIR PARTS

HARDWARE

TECHNICAL INFORMATION

NOTES

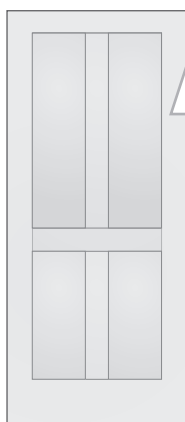

744

PRIMED
HEMLOCK



764

PRIMED
HEMLOCK

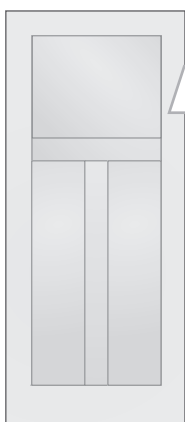

760

PRIMED
HEMLOCK

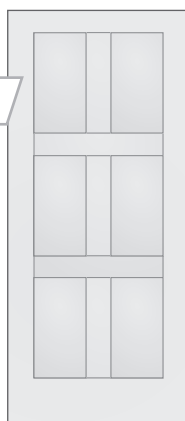

767

PRIMED
HEMLOCK

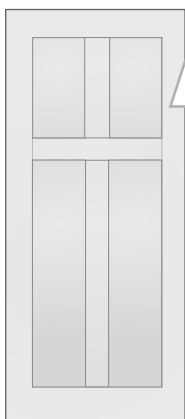

762

PRIMED
HEMLOCK

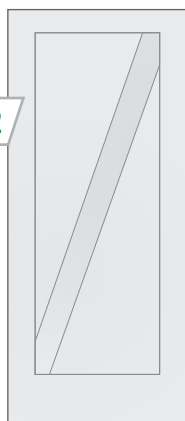

722

PRIMED
HEMLOCK

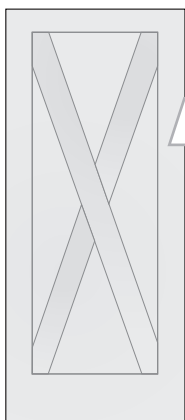

723

PRIMED
HEMLOCK

INTERIOR STILE & RAIL • TEMPERED SG
SHAKER CLAMP GLAZED • 6/8 & 8/0
(AVAILABLE IN 2/0, 2/4, 2/6, 2/8 AND 3/0 WIDTHS)



1520

CLEAR
TEMPERED SG
W/PROTECTIVE FILM

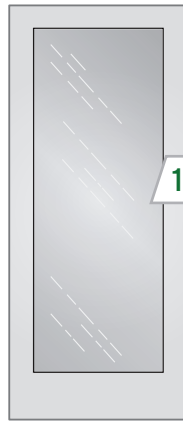

1520W

WHITE LAMI
LAMINATED
W/PROTECTIVE FILM

SDL Options are also available on 1520 and 1520W doors

Protective film will be removed
by Western Pacific
for the application of SDL mullions

1530

3 LITE



1555

5 LITE



1560

3 LITE

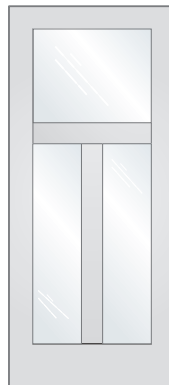

1582

2 LITE



1584

4 LITE



1585

3 LITE



MOULDING

FLAT STOCK

EXT FG DOORS

INT DOORS

STAIR PARTS

HARDWARE

TECHNICAL INFORMATION

NOTES

MOULDING

FLAT STOCK

EXT FG DOORS

INT DOORS

STAIR PARTS

HARDWARE

TECHNICAL INFORMATION

NOTES



Traditional (Farmhouse)*
1 - Panel
4 - Lite

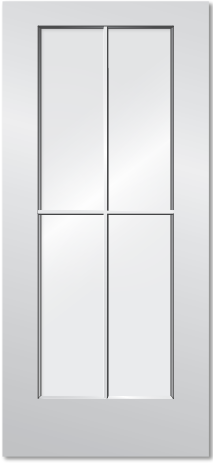

Traditional (Farmhouse)*
4- Lite
Flush Glaze

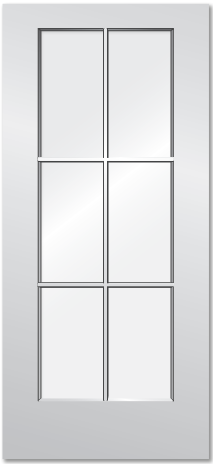

Traditional (Farmhouse)*
1 - Panel
Flush Glaze



Craftsman
6 - Lite
2 - Panel



Modern*
Flush Glaze
3 - Lite



Modern*
Flush Glaze
4 - Lite

HANDRAILS



Handrails can be plowed upon request

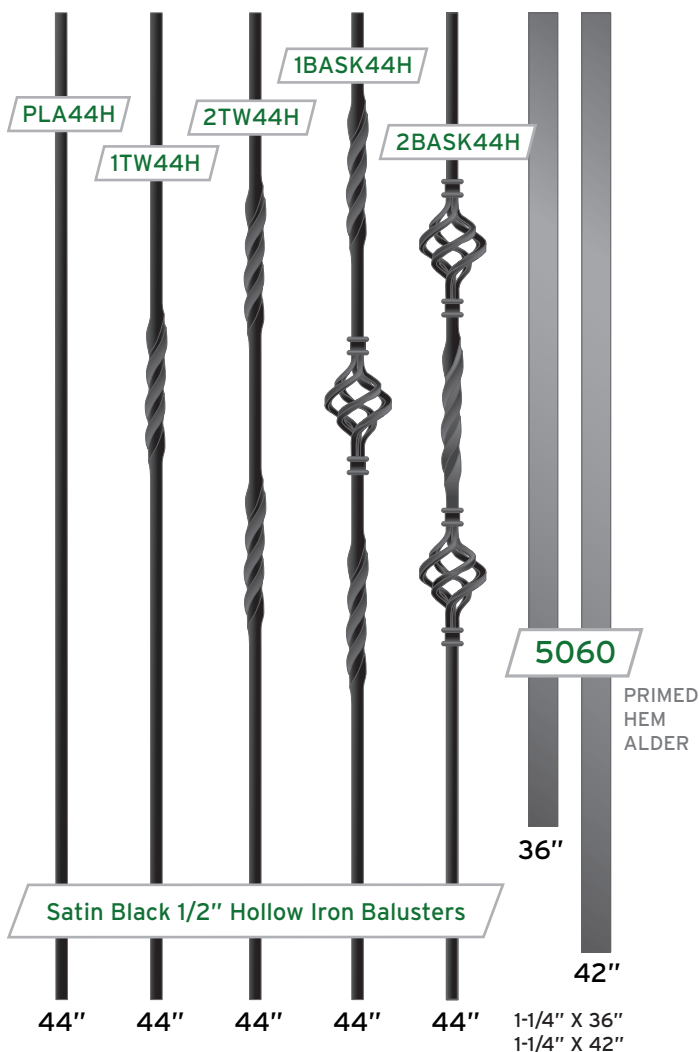

AK01A
ADJUSTABLE
KNUCKLE



M06A
FLAT SHOE



PSH02A
PITCH SHOE

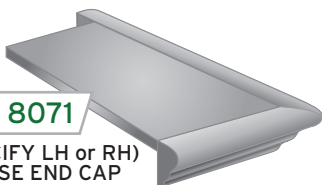

8071
(SPECIFY LH or RH)
FALSE END CAP



8076
FALSE RISER

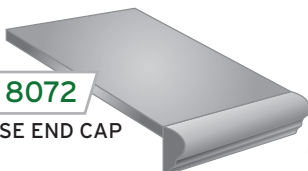

8072
FALSE END CAP

MOULDING

FLAT STOCK

EXT FG DOORS

INT DOORS

STAIR PARTS

HARDWARE

TECHNICAL INFORMATION

NOTES

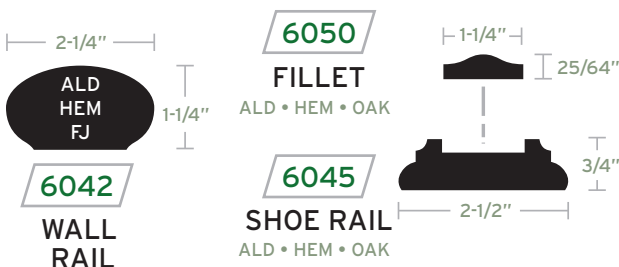
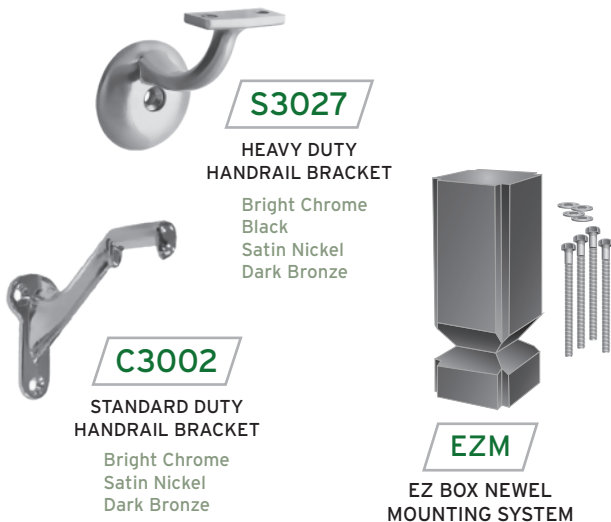
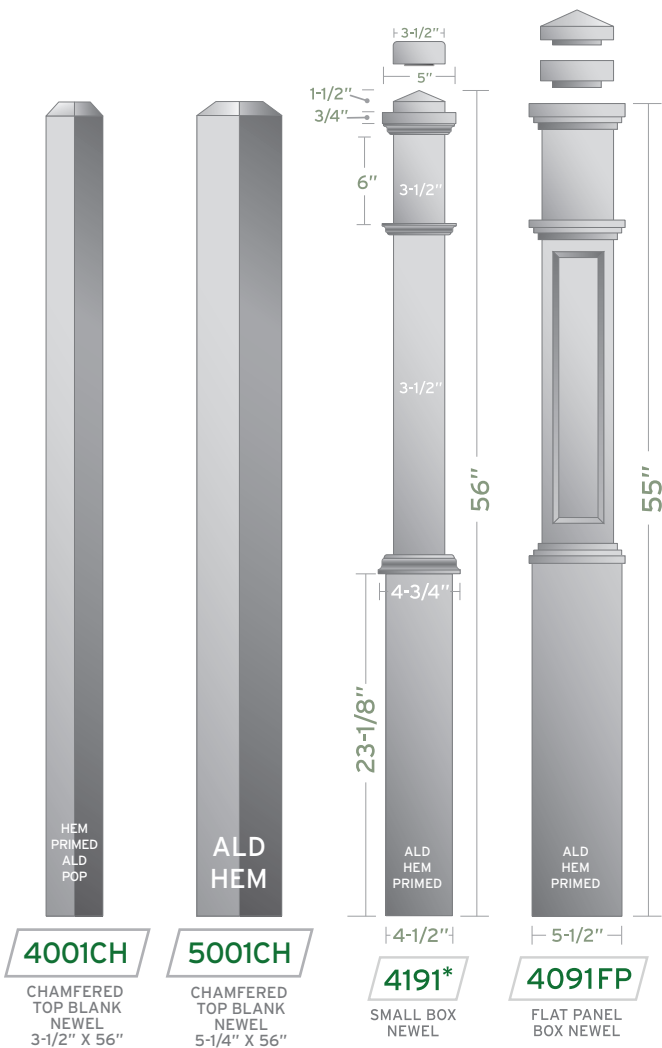

BARN DOOR HARDWARE

SLIDING DOOR HARDWARE SETS

BTBLK6 RUSTIC - BLACK
6' or 8' TRACK

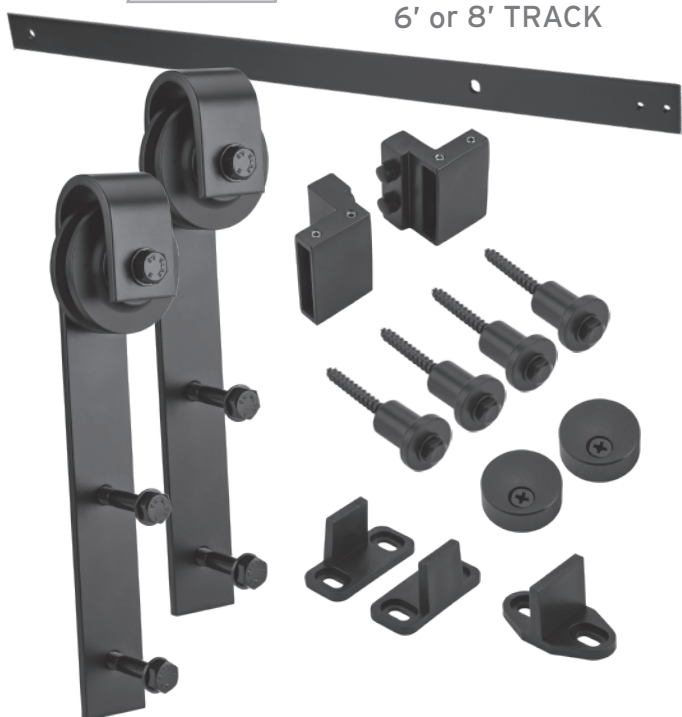

BTBA
TRACK JOINT ADAPTER

BTS6 MODERN - STAINLESS STEEL
6' or 8' TRACK

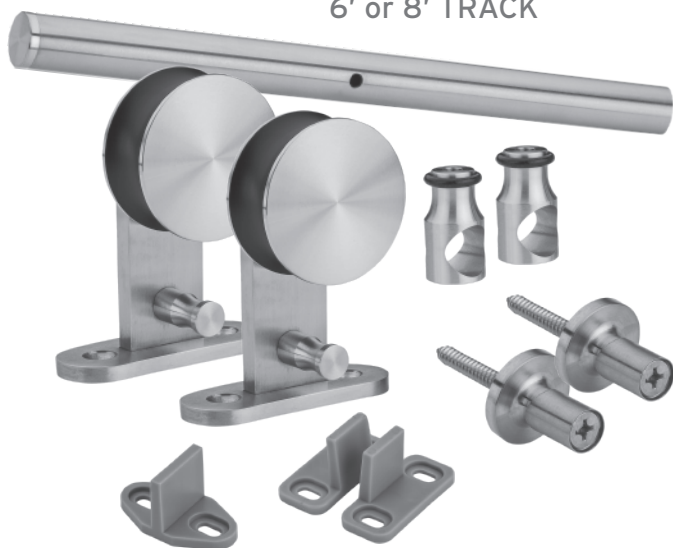

BTSA
TRACK JOINT ADAPTER

MOULDING

FLAT STOCK

EXT FG DOORS

INT DOORS

STAIR PARTS

HARDWARE

TECHNICAL INFORMATION

NOTES

SLIDING DOOR PULLS

MOULDING

FLAT STOCK

EXT FG DOORS

INT DOORS

STAIR PARTS

HARDWARE

TECHNICAL INFORMATION

NOTES

RBP

15" Round Bar Pull
7/8" Diameter
2" Projection

- US15
- US10B
- US26
- Black

48" and 72"
Lengths Available



EP

Edge Pull
Dimensions: 3/4" X 4"

- US15
- US10B
- US26
- Black

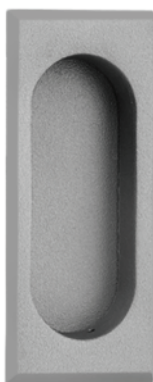

FPS

Rectangular Flush Pull
Dimensions: 1-3/4" X 4"
3/8" DEPTH

- US15
- US10B
- US26
- Black

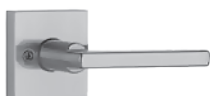

VANCOUVER

Handleset



TAVARIS

Handleset



CHELSEA

Handleset



HAWTHORNE

Handleset



SAN CLEMENTE

Handleset

MOULDING

FLAT STOCK

EXT FG DOORS

INT DOORS

STAIR PARTS

HARDWARE

TECHNICAL INFORMATION

NOTES

MOULDING

FLAT STOCK

EXT FG DOORS

INT DOORS

STAIR PARTS

HARDWARE

TECHNICAL INFORMATION

NOTES



POLO

Knob



LAUREL

Knob



HANCOCK

Knob



PISMO

Knob



939

Halo Deadbolt
Coded Keyless Entry



780

Deadbolt



UPTOWN 258R

Deadbolt



DOWNTOWN 258S

Deadbolt

LEVERS

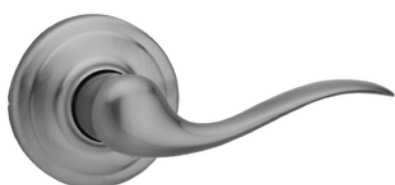

TUSTIN

Lever



BALBOA

Lever



LADERA

Lever



MILAN

Lever



LISBON

Lever



HALIFAX

Lever

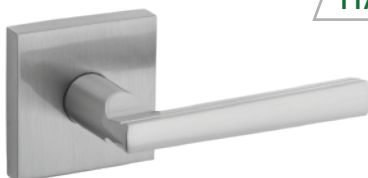

MONTREAL

Lever

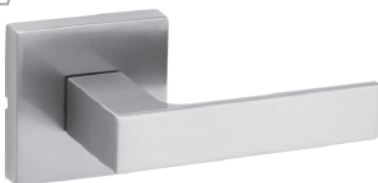

SINGAPORE

Lever

MOULDING

FLAT STOCK

EXT FG DOORS

INT DOORS

STAIR PARTS

HARDWARE

TECHNICAL INFORMATION

NOTES

FINISH LUMBER DESCRIPTIONS

3/4" thick with four square edges, and available in random lengths.

MOULDING

Custom Milling Available in all species:

- Sanding
- Ripping to Custom Width
- Planing to Custom Thickness

FLAT STOCK

RED OAK

Sapwood is white to light brown and the heartwood is a pink or reddish brown. Similar in appearance to White Oak, but with smaller grain rays. Red Oak is mostly straight-grained, with a coarse texture.

EXT FG DOORS

WHITE OAK

The sapwood is light-colored and the heartwood is light to dark brown. White Oak is mostly straight-grained with a medium to coarse texture, and with longer grain rays than red oak.

INT DOORS

EASTERN HARD MAPLE

Creamy white in color with a fine, uniform texture and generally mixed grain.

STAIR PARTS

AMERICAN CHERRY

Rich red to reddish brown. Will darken with age and on exposure to light. May contain some creamy white sapwood. Fine uniform, straight grain, satiny, smooth texture.

HARDWARE

CLEAR ALDER

Light brown with a yellow or reddish tinge. Fairly straight-grained with a uniform texture. Occasional pin knots may be present.

TECHNICAL INFORMATION

KNOTTY ALDER

Light brown with a yellow or reddish tinge. Fairly straight-grained with a uniform texture. Multiple large open and tight knots will be present.

NOTES

CVG FIR

Even, straight, vertical grain that stains out beautifully. Reddish in color. Also good for outdoors when painted.

CVG HEMLOCK

Our most popular stain grade softwood. A close relative of Fir but more yellowish in color. Fine uniform texture and vertical grain pattern, that easily obtains a rich finish. Also good for paint grade.

EASTERN POPLAR

Solid paint grade hardwood. Smooth and even surface that paints out beautifully. Our high quality Eastern Poplar is lighter in color, more dense, and less fuzzy when machining than Western varieties.

WALNUT

Light to dark chocolate brown in color, with straight grain from the trunk and more waved grain near the roots. Walnut is hard and durable with excellent shaping qualities, making it one of the most popular and versatile woodworking species. It takes finish very well.

STAINING INSTRUCTIONS

Recommended Wood Staining Procedure

WOOD PREPARATION

Wood must be dry and cleaned of dirt, grease, wax, polish, and marks. See STEP 1 for details.

(For exterior wood doors, Western Pacific recommends Epifanes Wood Finish Matte top coat for the best results and long lasting finish. (Available at Marine Supply. Epifanes.com)

THE "FINGERNAIL TEST"

Determine if you have a soft wood or a hard wood.

We consider Fir, Hemlock and Alder to be softwoods and Oak, Cherry and Maple are typically hardwoods. If your fingernail dents the surface when you scratch it, you have a soft wood.

Since soft woods tend to absorb stain unevenly and become blotchy easily, pre-treat the wood using pre-stain wood conditioner before staining. This **critical** extra step will help you control stain color penetration and prevent blotchiness.

CHOOSING A COLOR

Your finished color is determined by many factors, from the color of the stain selected to how long the stain is left on.

But remember: Different species of wood absorb stain differently. Test the color on an inconspicuous area or sample board before you start staining the most visible parts of your project.

Always stop your staining process if you are not achieving your desired finish and ask a painting professional for additional advice.

To assure the highest quality results when applying interior wood stain, follow these steps:

STEP 1: Start with a medium grade of sandpaper (e.g., 120-grit) and gradually work your way to a finer grade (e.g., 220-grit).

Sand in the direction of the grain for a smooth uniform finish, and remove all sanding dust (using a vacuum, dry paint brush or tack cloth) before finishing.

STEP 2: Mix the stain thoroughly before you begin and frequently while you're staining. This helps keep the color consistent throughout the project. Ingredients in stains and finishes can settle over time. Stir until all settlement is evenly dispersed. Shaking will only add unwanted bubbles to the product.

STEP 3: Before proceeding, apply the stain on a discreet area of wood to test the color.

TIP: ● ● ● ●

Apply stain only at the proper temperature. For most stains, 70°F is the optimum, with the safety range from 50° to 90°F.

Stains do vary, so check the label first. Avoid high humidity when applying stain. All finishes, including stains and paint, have trouble drying in moist conditions.

STEP 4: Apply stain by brushing or wiping it in the direction of the grain, using smooth, even strokes. Wipe off any excess.

TIP: ● ● ● ●

Avoid unattractive lap marks by applying stain from an unpainted area back into the last wet stain. In other words, don't let a section of stain dry before you blend it in with stain from an adjoining section.

STEP 5: Let dry completely (usually 24 hours).

Apply a second coat of stain if you want a darker look.

STEP 6: After the wood is dry, brush or spray on a uniform coat of your top coat product. After the top coat dries, lightly sand the trim using 220-grit sandpaper to eliminate brush strokes or paint drips. Use a damp sponge or tack cloth to remove all sanding dust. Recoat your top coat and follow the sanding procedure until your desired finish is achieved.

MOULDING

FLAT STOCK

EXT FG DOORS

INT DOORS

STAIR PARTS

HARDWARE

TECHNICAL INFORMATION

NOTES

PAINTING INSTRUCTIONS

Recommended Procedure To Paint Wood And MDF
Mouldings And Boards

MOULDING

FLAT STOCK

EXT FG DOORS

INT DOORS

STAIR PARTS

HARDWARE

TECHNICAL INFORMATION

NOTES

PART 1 • Prepare The Trim

STEP 1: Use a damp sponge to clean dirt and grime from trim. If needed, use the rough side of a sponge to ensure a clean starting surface.

STEP 2: Sand the surface. After the trim has been sanded, use a damp sponge to wipe away any dust.

SANDING TIP: If the trim is smooth, lightly sand using 120-grit sandpaper until all shine disappears from the trim. If the trim has a rough milling area start by sanding with coarse, 80-grit sandpaper. Then, move to less-coarse sandpaper such as 100 or 120-grit to smooth the surface.

STEP 3: Fill in holes, dents and cracks with a lightweight spackling compound. (Follow directions on the spackling container for best results.) When the spackle dries completely, lightly sand the spackled areas using 120-grit sandpaper to smooth out the surface. Use tack cloth to remove any sanding dust from the trim.

STEP 4: Dust off walls and ceiling around the trim to ensure painter's tape adheres well. Apply painter's tape to walls and ceilings surrounding the trim, being careful not to stick the tape to the trim itself. To prevent paint from bleeding through the tape, try to use one long piece of tape instead of multiple shorter pieces.

STEP 5: After you have applied the tape, press the tape's edges with a clean spackling or putty knife to ensure adhesion, as this helps prevent the paint from bleeding through the edges.

PART 2 • Paint The Trim And Boards

STEP 1: Apply primer to trim, covering any bare wood and spackled areas. Allow primer to dry for 24 hours. After the drying period, if bare wood or spackle is showing, apply another coat of primer to the trim.

STEP 2: After the primer dries, lightly sand the trim using 120-grit sandpaper to eliminate brush strokes or paint drips. Use a damp sponge or tack cloth to remove all sanding dust.

STEP 3: Apply paint to the trim using short, horizontal brush or spray-gun strokes. Repeat the motion until a few feet of trim (not the full length) are covered in paint.

STEP 4: Allow the paint to dry for 24 hours. After the drying period, for latex paint lightly sand the trim using 180-grit sandpaper to eliminate brush strokes or paint drips. Use a sponge or tack cloth to remove all sanding dust. Oil based paint does not require sanding between paint applications. Apply paint to the trim using short, horizontal brush or spray-gun strokes. Repeat the motion until a few feet of trim (not the full length) are covered in paint.

STEP 5: Before paint dries, carefully pull tape off of the wall and trim.

RETURNS

Material returns are subject to Western Pacific approval. Western Pacific will accept a return of a product, for credit, that has been purchased from Western Pacific inventory.

Western Pacific will not accept a return of product, for credit, that has been modified or damaged by a person or party other than Western Pacific. Examples of such product are millwork items that have been cut in length, hardware not in its original box, etc.

Furthermore, product ordered for a specific job, such as pre-hung doors, non-stock doors only, pre-finished millwork, etc., may not be returned for credit.

CANCELLATIONS & CHANGES

Once an order has been placed for custom items, pre-hung doors, or windows, the order may not be cancelled or otherwise changed.

WARRANTY

Western Pacific makes no representations or warranties, either expressed or implied, with respect to the building materials beyond those specifically made by the manufacturer. We can help coordinate warranty resolution for products, but it will be your responsibility to contact the manufacturer directly. Western Pacific is not responsible for any type of freight charges for warranty issues and is not responsible for warranty issues or discrepancies for products exported outside the USA.

DELIVERY

Western Pacific will make every effort to deliver all product in a timely manner. However, Western Pacific assumes no liability for theft, or delivery delays, beyond the reasonable control of Western Pacific.

PAYMENT

All charges are due and payable on the 10th of each month, except for cash accounts which are due prior to production. Any disputes must be raised within 10 days. Buyer acknowledges that any quotes or bids from Western Pacific are only for the materials listed and buyer assumes responsibility to ensure quantities are sufficient to complete the job.



November • 2022

LOCATIONS

Portland • Oregon

2805 NW 31st Avenue
Portland, Oregon 97210
Phone: 503-223-8818
Fax: 503-224-9129

Medford • Oregon

502 Parsons Drive
Medford, OR 97501
Phone: 541-772-8818
Fax: 541-770-3736

Seattle • Washington

1101 Industry Street
Everett, WA 98203
Phone: 425-366-8828
Fax: 425-742-5280

Bellevue • Washington Design Studio

13208 NE 20th Street • Suite 150
Bellevue, WA 98005
Phone: 425-250-8327
Fax: 425-558-5828

Denver • Colorado

320 S Lipan Street
Denver, CO 80223
Phone: 303-454-8811
Fax: 303-394-3312

Houston • Texas

7607 Bluff Point Drive
Houston, TX 77086
Phone: 832-975-0070
Fax: 832-975-0071

Austin • Texas

15855 Long Vista Dr. • Ste 103
Austin, TX 78728
Phone: 512-989-1445

HOURS

MONDAY - FRIDAY
7 AM - 4:30 PM

gowestpac.com